



PMA

PMA Overview

PMAFLEX | Conduits | Cable protection



Product	Description
PMA conduits	
PACOF	Flexible, medium, split
PPCOF	Very flexible, medium, split
LN	Two-part lock nuts
LNO	One-piece split connectors
VCS	Flexible, heavy
PIS/PIH	Highly flexible, medium
CYL	Very flexible, medium

PMAFIX | Connectors | Safety and sealing systems



Product	Description
PMA connectors	
IP66 - stat., IP54 dyn.	Universal safety clip
IP68 - stat., IP67 dyn.	Oval clip
PMAFIX / PMAFLEX	Connectors
PMAFIX connectors VW	90° elbow, PG
PMAFIX connectors VA	45° elbow, metric & PG
PMAFIX connectors VN	Straight, metric
PMAFIX connectors VN	Straight, PG
PMAFIX connectors VB	90° curved elbow, metric & PG
PMAFIX connectors VO	Flange 90°

PMA | Accessories



Product	Description
PMA accessories	
PMAFIX FH-O	One-piece system support
PMA VH	System supports
PMA GPS	One-piece system supports
PMA MN	Hexagonal lock nuts, metric & PG
PMA SGB	Tube clamps
PMA 514	Plug screws, metric & PG

PMA Protective Corrugated Tubing

Tubes, connectors, system supports, and accessories

PMA - corrugated conduits, connectors, system support, and accessories

- Wide range of tubes
- Long service life of the tubes especially through millions of reverse bending cycles
- UL-recognized products available
- PMAFIX safety locking system

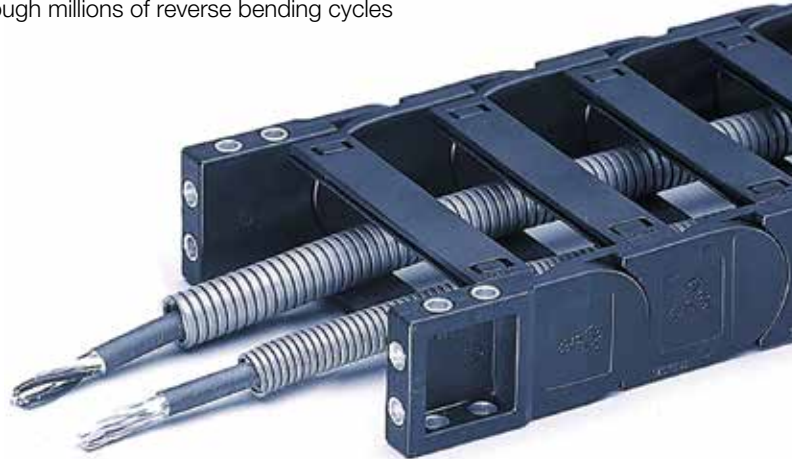

igus® E-Chain® System E4 combined with PMAFLEX protective tubing and igus Chainflex® CF9

PMA-Program - Wide selection of tubes and systems

The PMA cable protection system is applied wherever the mechanical protection of electrical wires and cables is required. Very flexible types of conduits are especially suitable for the additional protection of leads in E-Chain systems® if required. By combining technical excellence with rigorous international safety standards, PMA meets the demands of industry worldwide - specializing in applications from the machine building industries to high tech manufacturing; heavy plant and vehicle construction; fiber optics, solar energy and robotic applications with high speed and millions of reversed bending cycles.

PMAFLEX - Conduits

PMAFLEX covers different conduit types for a variety of applications in cable protection. The **PMAFLEX** range offers conduits for technically demanding applications and special requirements. Conduit sizes range from 4.5 mm to 125 mm diameters, from lightweight to heavyweight, and pliable to highly flexible. Standard colors are black and grey. Many conduits are specially approved, e.g. CSA, UL Recognition, NF, SNCF, DB, etc.

PMAFIX- Connectors

The designation **PMAFIX** describes a very large range of connectors for PMA conduits with the patented PMA safety clip system. Connectors are available for ingress protection IP66 and IP68. IP66 connectors are fitted with a pre-installed universal safety clip which ensures a quick "push-in" installation. IP68 connectors for increased requirements will be delivered with a special conduit seal cap.<?>



PMA COFLEX Conduit PACOF - medium, flexible, split

The PMA COFLEX conduit type PACOF has been created for retrofit and pre-loomed applications. New cables can be added to existing arrangements without the need for re-wiring or re-threading within the building of machines and installations. This product is suitable for vehicle manufacturing and building construction. Split connectors and locknuts are available for this product group.

Temperature range:

-40°F to +221°F (-40°C to +105°C), or a short time up to +320°F (+160°C)

Features:

- specially modified PA6 (polyamide 6)
- good closure up to IP50
- self-extinguishing
- halogen-free and cadmium-free

Chemical resistance:

- fuels
- mineral oils
- fats
- alkalis
- weak acids and bases, etc.

Part No. structure

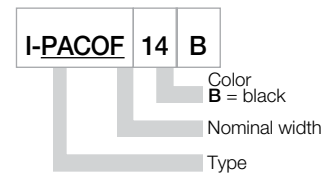

Part No. (Black)	Conduit size		Inside diameter d1 (mm)	Outside diameter d2 (mm)	Radius (stat.) (mm)	PU (m)
	Nominal	Metric				
I-PACOF-07B	7	10	5.6	10.0	30	50
I-PACOF-10B	10	12	8.5	12.8	33	50
I-PACOF-12B	12	16	11.0	15.6	35	50
I-PACOF-17B	17	20	15.5	21.1	45	50
I-PACOF-23B	23	25	22.1	28.4	70	50
I-PACOF-29B	29	32	27.2	34.5	120	50
I-PACOF-36B	36	40	32.0	42.4	145	30
I-PACOF-48B	48	50	43.9	54.1	150	30
I-PACOF-70B	70	80	66.0	80.0	220	10

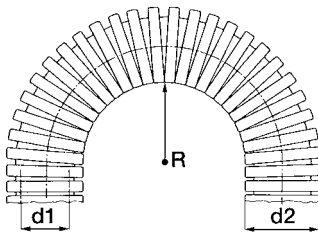

** *stat. R* = lowest recommended bending radius for static (fixed) installation

**I-PACOF -
is suitable for
static use only!**



PMA COFLEX Conduit PPCOF - medium, very flexible, split

The PMA COFLEX conduit type PPCOF has been created for retrofit and pre-loomed applications. New cables can be added to existing arrangements without the need for re-wiring or re-threading within the building of machines and installations. This product is suitable for vehicle manufacturing and building construction. Split connectors and locknuts are available for this product group.

Temperature range:

-4°F to +221°F (-20 °C to +105 °C), or a short time up to +275°F (+135°C)

Features:

- specially modified polypropylene
- good closure up to IP50
- self-extinguishing,

Chemical resistance:

- fuels
- mineral oils
- fats
- alkalis
- acids, etc.

Part No. structure

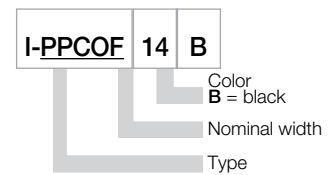

Part No. (Black)	Conduit size		Inside diameter d1 (mm)	Outside diameter d2 (mm)	Radius (stat.) (mm)	PU (m)
	Nominal	Metric				
I-PPCOF-07B	7	10	5.9	10	25	50
I-PPCOF-10B	10	12	8.5	12.8	28	50
I-PPCOF-12B	12	16	11.0	15.6	35	50
I-PPCOF-17B	17	20	15.1	21.1	45	50
I-PPCOF-23B	23	25	21.1	28.4	60	50
I-PPCOF-29B	29	32	26.6	34.5	100	50
I-PPCOF-36B	36	40	31.8	42.4	120	30
I-PPCOF-48B	45	50	43.9	54.1	140	30

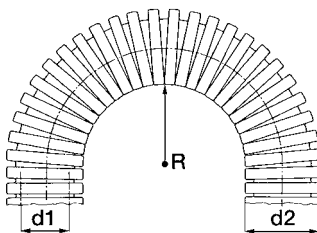

** *stat. R* = lowest recommended bending radius for static (fixed) installation



LN - Two-part Lock Nut - metric

These split counter nuts are ideal in conjunction with TN fittings for the smooth re-installation and repair in machinery and plant construction. In addition, this product is becoming increasingly important in automotive construction and in building installation technology.

Temperature range:

-22°F to +212°F (-30 °C to +100 °C), or a short time up to +266°F (+130°C)

Features:

- specially formulated polyamide
- self-extinguishing
- free of halogen, cadmium and phosphor
- very good impact strength

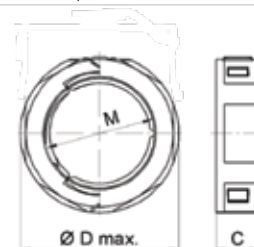

PMA-COFIX LN: Two-part lock nut, metric

Part No. Black	Thread M metric	Fits PMA COFLEX LNO		Outer diameter (mm)	Width C (mm)
I-BLN-M16	M16 x 1.5	I-BLNO-M160	I-BLNO-M162	21.5	8.0
I-BLN-M20	M20 x 1.5	I-BLNO-M202	I-BLNO-M207	29.5	8.0
I-BLN-M25	M25 x 1.5	I-BLNO-M257	I-BLNO-M253	35.5	9.0
I-BLN-M32	M32 x 1.5	I-BLNO-M323	I-BLNO-M329	44.5	12.0
I-BLN-M40	M40 x 1.5	I-BLNO-M409	I-BLNO-M406	53.5	15.0
I-BLN-M50	M50 x 1.5	I-BLNO-M508		69.5	15.0



LNO - One-piece split connector, straight

These split lock nuts are used in conjunction with the connectors TN for repairs or where cable protection systems are installed after wiring has taken place in the machine building and installation industry. Further, these products will be used increasingly in the vehicle building and building construction.

Temperature range:

-22°F to +212°F (-30 °C to +100 °C), or a short time up to +266°F (+130°C)

Features:

- specially formulated polyamide
- IP50
- self-extinguishing
- free of halogen, cadmium and phosphor
- very good impact strength



PMA-COFIX LNO: one-piece split connector

Part No. Black	Thread metric	Fits conduit size		Thread length g (mm)	Overall length L (mm)
		NW	metric		
I-BLNO-M160	M16 x 1.5	12	16	13.0	36.5
I-BLNO-M162	M16 x 1.5	12	16	13.0	39.5
I-BLNO-M202	M20 x 1.5	12	16	13.0	39.5
I-BLNO-M207	M20 x 1.5	17	20	13.0	43.5
I-BLNO-M257	M25 x 1.5	17	20	14.0	44.5
I-BLNO-M253	M25 x 1.5	23	25	14.0	52.5
I-BLNO-M323	M32 x 1.5	23	25	17.0	56.0
I-BLNO-M329	M32 x 1.5	29	32	17.0	61.0
I-BLNO-M409	M40 x 1.5	29	32	21.0	65.0
I-BLNO-M406	M40 x 1.5	34	40	22.0	74.5
I-BLNO-M508	M50 x 1.5	48	50	22.0	80.5

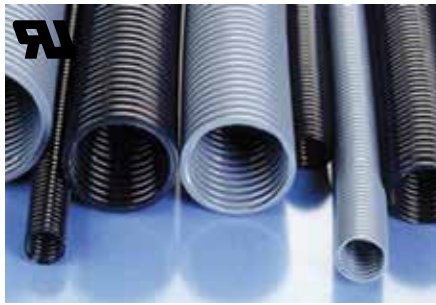

PMAFLEX Conduits VCS - flexible, heavy

PMAFLEX VCS heavy conduit is characterized by high impact resistance at low temperatures and good weather resistance. These conduits find their application primarily in railway vehicle undercarriages, but are also well-suited to static applications in general construction of machinery or installations.

Temperature range:

-58°F to +221°F (-50 °C to +105 °C), or a short time up to +302°F (+150°C)

Features:

- specially modified PA6 (polyamide 6) for cold impact
- excellent mechanical properties also at low temperatures
- self-extinguishing
- halogen-free and cadmium-free

Chemical resistance:

- fuels
- mineral oils
- fats
- alkalis
- weak acids and bases, etc.

Part No. structure

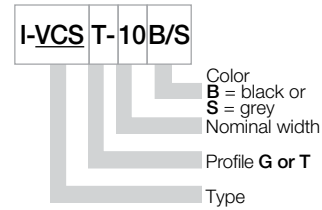

Part No. black	Part No. grey*	Conduit size NW	Conduit size metric	Inside diameter (mm)	Outside diameter (mm)	Radius (stat.)** (mm)	PU (m)
I-VCST-07B	I-VCST-07S	7	10	6.0	10.0	20	100
I-VCST-10B	I-VCST-10S	10	12	9.2	13.0	25	50
I-VCST-12B	I-VCST-12S	12	16	11.8	15.8	30	50
I-VCST-17B	I-VCST-17S	17	20	16.0	21.2	40	50
I-VCSG-17B	I-VCSG-17S	17	20	15.2	21.2	40	50
I-VCSG-23B	I-VCSG-23S	23	25	22.0	28.5	50	50
I-VCSG-29B	I-VCSG-29S	29	32	27.7	34.4	60	50
I-VCSG-36B	I-VCSG-36S	36	40	35.8	42.4	70	30
I-VCSG-48B	I-VCSG-48S	48	50	46.8	54.4	80	30
I-VCSG-56B	I-VCSG-56S	56	68	56.1	67.2	150	30
I-VCSG-70B	I-VCSG-70S	70	80	66.5	80.0	200	10
I-VCSG-95B	I-VCSG-95S	95	106	91.0	106.0	300	10

*Grey part is a special order, call igus® for availability

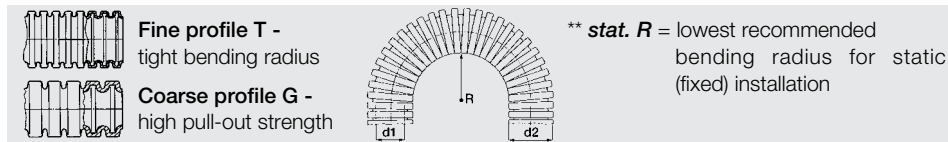

I-VCST/VCSG - is suitable for static use only!



PMAFLEX Conduits PIS/PIH - highly flexible, medium

These highly flexible products are used primarily in automation applications and for connections subject to intense movements in general machinery construction. Their outstanding material properties make these conduits especially suitable for outdoor applications where they are exposed to intensive sunlight (UV).

Temperature range:

-58°F to +203°F (-50 °C to +95 °C), or a short time up to +302°F (+150°C)

Features:

- specially modified polyamide 12
- **PIS: medium-wall (nominal width 07 to 48**
- **PIH: heavy-wall (nominal width 56 to 125)**
- self-extinguishing
- halogen-free and cadmium-free
- good mechanical properties also at low temperatures

Chemical resistance:

- fuels
- mineral oils
- fats
- alkalis
- acids etc.

Part No. structure

I-PIS T-48B/S

Color
B = black or
S = grey
 Nominal width
 Profile **T** or **G**
 Type

Part No. black	Part No. grey*	Conduit size NW	Conduit size metric	Inside diameter (mm)	Outside diameter (mm)	Radius stat.**/dyn.*** (mm)	PU (m)
I-PIST-07B	I-PIST-07S	7	10	6.2	10.0	15 / 40	50
I-PIST-10B	I-PIST-10S	10	12	9.6	13.0	20 / 50	50
I-PIST-12B	I-PIST-12S	12	16	11.9	15.8	25 / 65	50
I-PIST-17B	I-PIST-17S	17	20	16.4	21.1	30 / 65	50
I-PIST-23B	I-PIST-23S	23	25	22.6	28.4	35 / 90	50
I-PIST-29B	I-PIST-29S	29	32	29.0	34.3	45 / 110	50
I-PIST-36B	I-PIST-36S	36	40	36.5	42.5	60 / 165	30
I-PIST-48B	I-PIST-48S	48	50	47.5	54.5	70 / 180	30
I-PISG-17B	-	17	20	15.2	21.1	30 / 80	50
I-PISG-23B	I-PISG-23S	23	25	21.7	28.4	40 / 100	50
I-PISG-29B	I-PISG-29S	29	32	27.4	34.3	50 / 120	50
I-PISG-36B	I-PISG-36S	36	40	35.8	42.3	60 / 180	30
I-PISG-48B	I-PISG-48S	48	50	46.7	54.2	70 / 200	30
I-PIHG-56B	I-PIHG-56S	56	68	56.3	67.2	110 / 270	30
I-PIHG-70B	I-PIHG-70S	70	80	67.2	79.6	150 / 350	30
I-PIHG-95B	I-PIHG-95S	95	106	91.3	106.0	170 / 450	30
I-PIHG-125B	I-PIHG-125S	125	146	126.5	146.5	350 / 580	20

*Grey part is a special order, call igus® for availability

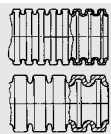

Fine profile T -
tight bending radius

Coarse profile G -
high pull-out strength

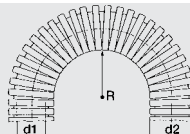

** *stat. R* = lowest recommended bending radius for static (fixed) installation

*** *dyn. R* = lowest recommended bending radius for dynamic (flexible) installation

I-PIS/PIH is recommended for highly flexible application



PMAFLEX Conduits CYL - very flexible, medium, economy

PMA CYL ECONOMY conduit exhibits very good flexibility and is also suitable for low temperature applications. These conduits are used primarily in construction of machinery and equipment.

Temperature range:

-40°F to +221°F (-40 °C to +105 °C), or a short time up to +302°F (+150°C)

Features:

- specially modified polyamide 6/6.6 for cold impact
- good impact strength also at low temperatures
- self-extinguishing
- halogen-free and cadmium-free

Chemical resistance:

- fuels
- mineral oils
- fats
- alkalis
- weak acids and bases, etc.

Part No. structure

I-CYL T-29B/S

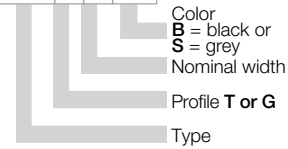

Part No. black	Part No. grey*	Conduit size NW	Conduit size metric	Inside diameter (mm)	Outside diameter (mm)	Radius (stat.)** (mm)	PU (m)
I-CYLT-07B	I-CYLT-07S	7	10	6.2	10.0	15	50
I-CYLT-10B	I-CYLT-10S	10	12	9.6	13.0	20	50
I-CYLT-12B	I-CYLT-12S	12	16	12.0	15.8	30	50
I-CYLT-17B	I-CYLT-17S	17	20	16.2	21.2	40	50
I-CYLT-23B	I-CYLT-23S	23	25	22.6	28.5	40	50
I-CYLT-29B	I-CYLT-29S	29	32	29.0	34.5	50	50
I-CYLT-36B	I-CYLT-36S	36	40	36.5	42.5	60	30
I-CYLT-48B	I-CYLT-48S	48	50	47.5	54.5	70	30
I-CYLG-23B	I-CYLG-23S	23	25	21.9	28.5	45	50
I-CYLG-29B	I-CYLG-29S	29	32	27.6	34.5	55	50
I-CYLG-36B	I-CYLG-36S	36	40	36.0	42.5	60	30
I-CYLG-48B	I-CYLG-48S	48	50	47.0	54.5	70	30
I-CYLG-56B	-	56	68	56.3	67.2	120	30
I-CYLG-70B	-	70	80	68.0	80.0	160	30
I-CYLG-95B	-	95	106	91.9	106.0	210	10
I-CYLG-125B	-	125	146	126.5	146.5	450	6

*Grey part is a special order, call igus® for availability

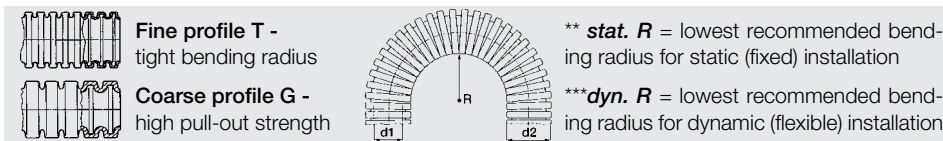

** *stat. R* = lowest recommended bending radius for static (fixed) installation

*** *dyn. R* = lowest recommended bending radius for dynamic (flexible) installation

I-CYLT/CYLG - is recommended for static use!

(moderate dynamic application possible)

igus®
e-chain system®

Telephone 1-800-521-2747

Internet: igus.com
email: sales@igus.com
QuickSpec: igus.com/quickspec

IP66 - static, IP54 dynamic - universal safety clip

- One piece Fitting, sealing by cone
- Easy “push-in” installation
- Pre-installed safety clip AFN2
- Fits any type of conduit profile (T and G)
- Excellent pull-out strength
- Re-opening for safety reasons only possible with a screwdriver
- Clip pre-installed in all IP66 connectors



Installation



1 Push in conduit with a slight twist (open using screwdriver on conduit side)



2 Pull back slightly to ensure the locking mechanism is fully engaged



3 To re-open use a screwdriver

IP68 - static - oval clip

- High sealing through additional seal cap
- For highest dynamic applications
- Fits any type of conduit profile (T and G)
- Excellent pull-out strength
- Re-opening for safety reasons only possible with a screwdriver



Installation



A Conduit,
B Seal cap,
C Connector,
D Oval clip,
E flat gasket (or O-ring seal)



2 Push seal cap onto end of conduit to achieve IP68



3 For ease of installation moisten seal cap with water or grease



4 Push conduit with seal cap fully into connector. This guarantees PMA's unique IP68/67 rating*



5 Install retaining oval clip

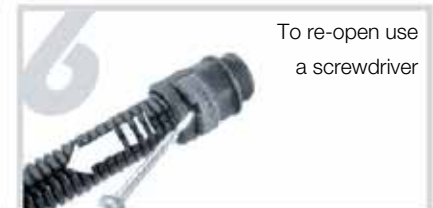

6 To re-open use a screwdriver

* For safety reasons, oval clip will not fit if seal cap is not fully installed.

Ensure to follow O-ring manufacturers guidelines when using O-rings for sealing purposes.

PMAFIX - Connectors

The designation **PMAFIX** describes a very large range of connectors for PMA conduits with the patented PMA safety clip system. Connectors are available for ingress protection IP66 and IP68. IP66 connectors are fitted with a preinstalled universal safety clip which ensures a quick "push-in" installation. IP68 connectors for increased requirements will be delivered with a special conduit seal cap.

Table 1 - PMAFIX / PMAFLEX conduit code

Nominal width	PMA code
7	M
10	0
12	2
17	7
23	3
29	9
36	6
48	8

Table 2 - Thread codes

Thread metric	PMA code	Thread PG	PMA code
M12 x 1.5	M12	PG07	P07
M16 x 1.5	M16	PG09	P09
M20 x 1.5	M20	PG11	P11
-	-	PG13.5	P13
M25 x 1.5	M25	PG16	P16
M32 x 1.5	M32	PG21	P21
M40 x 1.5	M40	PG29	P29
M50 x 1.5	M50	PG36	P36
M63 x 1.5	M63	PG42	P42
		PG48	P48

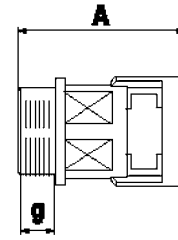

g = Thread length
A = Overall length

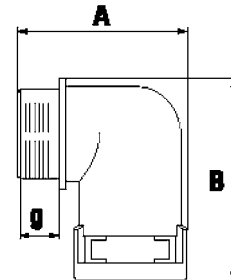

g = Thread length
A x B = External dimensions

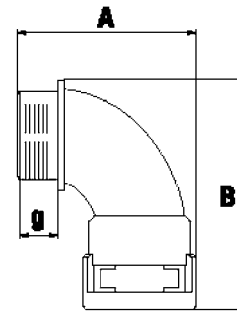

g = Thread length
A x B = External dimensions

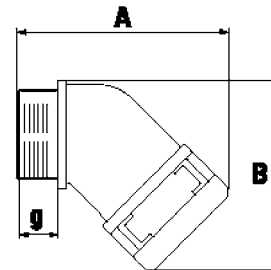

g = Thread length
A x B = External dimensions

igus®
e-chain system®

Telephone 1-800-521-2747

Internet: igus.com
email: sales@igus.com
QuickSpec: igus.com/quickspec

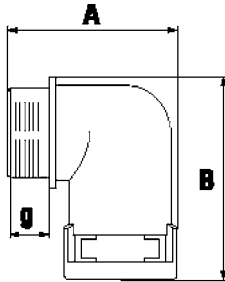

g = Thread length

A x B = External dimensions

PMAFIX Connectors VW - 90° elbow, PG

These PMAFIX connectors are used in a wide range of applications. Together with PMAFLEX conduits they offer the highest grade of safety and sealing.

Temperature range:

-40°F to +221°F (-40 °C to +105 °C), or a short time up to +320°F (+160°C)

Content of delivery IP66:

Fitting with pre-assembled universal safety clips (AFN2)

Content of delivery IP68:

Fitting with oval clips (OVN2), conduit and thread seal (NVN3, SVN4)

Features:

- high grade formulated polyamide
- excellent impact strength
- self-extinguishing
- free of halogen, phosphor and cadmium

Part No. IP66	Part No. IP68	Thread	Fits to conduit size:		Thread metric	External length [mm]	dim. [mm]
			PG	NW			
I-__VWD-PG07MGT-11	I-__VWV-PG07M	7	7	10	(11.0)	32.0 x 35.0	
I-__VWD-PG070GT-11	I-__VWV-PG070	7	10	12	(11.0)	34.0 x 39.5	
I-__VWD-PG09MGT-11	—	9	7	10	(11.0)	32.0 x 36.5	
I-__VWD-PG090GT-11	I-__VWV-PG090	9	10	12	(11.0)	34.0 x 39.5	
I-__VWD-PG092GT-11	I-__VWV-PG092	9	12	16	(11.0)	38.5 x 44.5	
I-__VWD-PG11MGT-11	—	11	7	10	(11.0)	32.0 x 38.0	
I-__VWD-PG110GT-11	I-__VWV-PG110	11	10	12	(11.0)	34.0 x 41.0	
I-__VWD-PG112GT-11	I-__VWV-PG112	11	12	16	(11.0)	38.5 x 46.0	
I-__VWD-PG13MGT-11	—	13.5	7	10	(11.0)	32.0 x 39.5	
I-__VWD-PG130GT-11	I-__VWV-PG130	13.5	10	12	(11.0)	34.0 x 42.5	
I-__VWD-PG132GT-11	I-__VWV-PG132	13.5	12	16	(11.0)	38.5 x 47.5	
I-__VWD-PG137GT-11	I-__VWV-PG137	13.5	17	20	(11.0)	43.5 x 58.5	
I-__VWD-PG167GT-11	I-__VWV-PG167	16	17	20	(11.0)	43.5 x 58.5	
I-__VWD-PG213GT	I-__VWV-PG213	21	23	25	(11.0)	54.0 x 67.0	
I-__VWD-PG299GT	I-__VWV-PG299	29	29	32	(12.0)	61.5 x 74.5	
I-__VWD-PG366GT	I-__VWV-PG366	36	36	40	(13.0)	72.0 x 98.0	
I-__VWD-PG488GT	I-__VWV-PG488	48	48	50	(13.0)	85.5 x 111.0	

Fill in the blank with either "B" to order black or "S" to order grey*

For smaller conduit sizes NW 07 to NW 12 appropriate standard elbows of type VB are available

*Grey part is a special order, call igus® for availability

Part No. structure PG

I-B/SVWD PG213 GT



Universal
safety clip
NW conduit
Thread size
PG thread
Type

B = black or
S = grey



PMAFIX Connectors VA - 45° elbow, metric & PG

These PMAFIX connectors are used in a wide range of applications. Together with PMAFLEX conduits they offer the highest grade of safety and sealing.

Temperature range:

-40°F to +221°F (-40 °C to +105 °C), or a short time up to +320°F (+160°C)

Content of delivery IP66:

Fitting with pre-assembled universal safety clips (AFN2)

Content of delivery IP68:

Fitting with oval clips (OVN2), conduit and thread seal (NVN3, SVN4)

Features:

- high grade formulated polyamide
- excellent impact strength
- self-extinguishing
- free of halogen, phosphor and cadmium

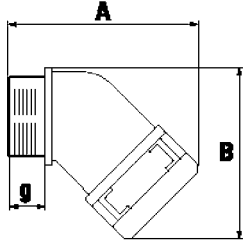

g = Thread length

A x B = External dimensions

Part No. IP66	Part No. IP68	Thread metric	Fits to conduit size:		Thread length [mm]	External dim. [mm]
			NW	metric		
I-_VAD-M120GT	—	M12 x 1.5	10	12	11.0	43.5 x 37.0
I-_VAD-M160GT	I-_VAV-M160	M16 x 1.5	10	12	11.0	43.5 x 38.0
I-_VAD-M162GT	I-_VAV-M162	M16 x 1.5	12	16	11.0	48.0 x 40.0
I-_VAD-M202GT	I-_VAV-M202	M20 x 1.5	12	16	11.0	48.0 x 41.5
I-_VAD-M207GT	I-_VAV-M207	M20 x 1.5	17	20	11.0	55.5 x 51.5
I-_VAD-M253GT	I-_VAV-M253	M25 x 1.5	23	25	12.0	65.0 x 58.5
I-_VAD-M329GT	I-_VAV-M329	M32 x 1.5	29	32	15.0	73.5 x 66.5
I-_VAD-M406GT	I-_VAV-M406	M40 x 1.5	36	40	19.0	92.5 x 85.5
I-_VAD-M506GT	I-_VAV-M506	M50 x 1.5	36	40	19.0	100.0 x 89.5
I-_VAD-M508GT	I-_VAV-M508	M50 x 1.5	48	50	19.0	100.0 x 96.0
I-_VAD-M638GT	I-_VAV-M638	M63 x 1.5	48	50	19.0	100.0 x 104.0

Part No. IP66	Part No. IP68	Thread PG	Fits to conduit size:		Thread length [mm]	External dim. [mm]
			NW	metric		
I-_VAD-P090GT	I-_VAV-P090	9	10	12	11.0	43.5 x 37.0
I-_VAD-P112GT	I-_VAV-P112	11	12	16	11.0	48.0 x 40.0
I-_VAD-P132GT	I-_VAV-P132	13.5	12	16	11.0	48.0 x 41.5
I-_VAD-P137GT	I-_VAV-P137	13.5	17	20	11.0	55.0 x 50.0
I-_VAD-P167GT	I-_VAV-P167	16	17	20	11.0	55.0 x 51.5
I-_VAD-P213GT	I-_VAV-P213	21	23	25	12.0	67.0 x 59.0
I-_VAD-P299GT	I-_VAV-P299	29	29	32	12.0	69.0 x 67.0
I-_VAD-P366GT	I-_VAV-P366	36	36	40	13.0	86.0 x 86.0
I-_VAD-P488GT	I-_VAV-P488	48	48	50	13.0	93.0 x 99.0

Fill in the blank with either "B" to order black or "S" to order grey*

*Grey part is a special order, call igus® for availability

Part No. structure metric

Part No. structure PG

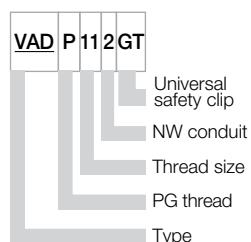
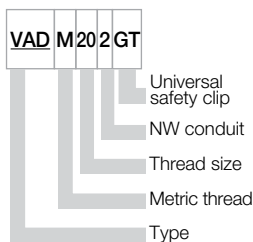

igus®
e-chain system®

Telephone 1-800-521-2747

Internet: igus.com
email: sales@igus.com
QuickSpec: igus.com/quickspec



PMAFIX Connectors VN - straight, metric

These PMAFIX connectors are used in a wide range of applications. Together with PMAFLEX conduits they offer the highest grade of safety and sealing.

Temperature range:

-40°F to +221°F (-40 °C to +105 °C), or a short time up to +320°F (+160°C)

Content of delivery IP66:

Fitting with pre-assembled universal safety clips (AFN2)

Content of delivery IP68:

Fitting with oval clips (OVN2), conduit and thread seal (NVN3, SVN4)

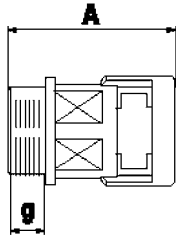

Features:

- high grade formulated polyamide
- excellent impact strength
- self-extinguishing
- free of halogen, phosphor and cadmium

Part No. IP66	Part No. IP68	Thread metric	Fits to conduit size:		Thread length [mm]	Overall length [mm]
			NW	metric		
I-_VND-M12MGT	I-_VNV-M12M	M12 x 1.5	7	10	11.0	34.5
I-_VND-M120GT	I-_VNV-M120	M12 x 1.5	10	12	11.0	36.5
I-_VND-M160GT	I-_VNV-M160	M16 x 1.5	10	12	11.0	36.5
I-_VND-M162GT	I-_VNV-M162	M16 x 1.5	12	16	11.0	39.5
I-_VND-M202GT	I-_VNV-M202	M20 x 1.5	12	16	11.0	39.5
I-_VND-M207GT	I-_VNV-M207	M20 x 1.5	17	20	11.0	47.5
I-_VND-M257GT	I-_VNV-M257	M25 x 1.5	17	20	12.0	48.5
I-_VND-M253GT	I-_VNV-M253	M25 x 1.5	23	25	12.0	52.0
I-_VND-M323GT	I-_VNV-M323	M32 x 1.5	23	25	15.0	55.5
I-_VND-M329GT	I-_VNV-M329	M32 x 1.5	29	32	15.0	56.0
I-_VND-M409GT	I-_VNV-M409	M40 x 1.5	29	32	19.0	60.0
I-_VND-M406GT	I-_VNV-M406	M40 x 1.5	36	40	19.0	72.5
I-_VND-M506GT	I-_VNV-M506	M50 x 1.5	36	40	19.0	72.0
I-_VND-M508GT	I-_VNV-M508	M50 x 1.5	48	50	19.0	72.5
I-_VND-M638GT	I-_VNV-M638	M63 x 1.5	48	50	19.0	72.0

Fill in the blank with either "B" to order black or "S" to order grey*

*Grey part is a special order, call igus® for availability

Part No. structure metric

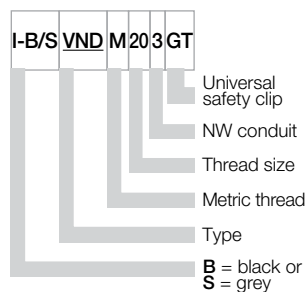



PMAFIX Connectors VN - straight, PG

These PMAFIX connectors are used in a wide range of applications. Together with PMAFLEX conduits they offer the highest grade of safety and sealing.

Temperature range:

-40°F to +221°F (-40 °C to +105 °C), or a short time up to +320°F (+160°C)

Content of delivery IP66:

Fitting with pre-assembled universal safety clips (AFN2)

Content of delivery IP68:

Fitting with oval clips (OVN2), conduit and thread seal (NVN3, SVN4)

Features:

- high grade formulated polyamide
- excellent impact strength
- self-extinguishing
- free of halogen, phosphor and cadmium

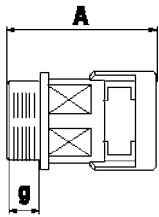

Part No. IP66	Part No. IP68	Thread PG	Fits to conduit size: NW	metric	Thread length [mm]	Overall length [mm]
I-__VND-P07MGT-11	I-__VNV-P07M	7	7	10	11.0	34.5
I-__VND-P070GT-11	I-__VNV-P070	7	10	12	11.0	36.5
I-__VND-P072GT-11	—	7	12	16	11.0	39.0
I-__VND-P09MGT-11	I-__VNV-P09M	9	7	10	11.0	34.5
I-__VND-P090GT-11	I-__VNV-P090	9	10	12	11.0	36.5
I-__VND-P092GT-11	I-__VNV-P092	9	12	16	11.0	39.0
I-__VND-P097GT-11	I-__VNV-P097	9	17	20	11.0	47.5
I-__VND-P11MGT-11	I-__VNV-P11M	11	7	10	11.0	34.5
I-__VND-P110GT-11	I-__VNV-P110	11	10	12	11.0	36.5
I-__VND-P112GT-11	I-__VNV-P112	11	12	16	11.0	39.0
I-__VND-P117GT-11	I-__VNV-P117	11	17	20	11.0	47.5
I-__VND-P13MGT-11	—	13.5	7	10	11.0	34.5
I-__VND-P130GT-11	I-__VNV-P130	13.5	10	12	11.0	36.5
I-__VND-P132GT-11	I-__VNV-P132	13.5	12	16	11.0	39.0
I-__VND-P137GT-11	I-__VNV-P137	13.5	17	20	11.0	47.5
I-__VND-P160GT-11	—	16	10	12	11.0	36.5
I-__VND-P162GT-11	I-__VNV-P162	16	12	16	11.0	39.0
I-__VND-P167GT-11	I-__VNV-P167	16	17	20	11.0	47.5
I-__VND-P163GT-11	I-__VNV-P163	16	23	25	11.0	51.0
I-__VND-P213GT	I-__VNV-P213	21	23	25	12.0	52.0
I-__VND-P299GT	I-__VNV-P299	29	29	32	12.0	53.0
I-__VND-P296GT	I-__VNV-P296	29	36	40	12.0	67.5
I-__VND-P366GT	I-__VNV-P366	36	36	40	13.0	66.0
I-__VND-P368GT	—	36	48	50	13.0	68.5
I-__VND-P428GT	I-__VNV-P428	42	48	50	13.0	68.5
I-__VND-P488GT	I-__VNV-P488	48	48	50	13.0	66.5

Fill in the blank with either "B" to order black or "S" to order grey*

*Grey part is a special order, call igus® for availability

Part No. structure PG

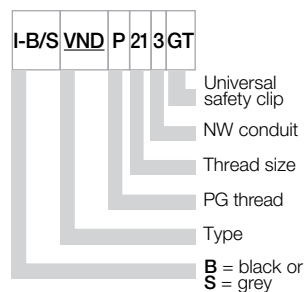

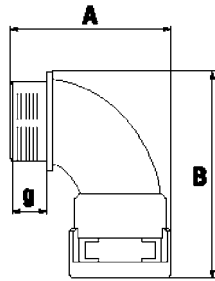

g = Thread length

A x B = External dimensions

PMAFIX Connectors VB - 90° curved elbow, metric & PG

These PMAFIX connectors are used in a wide range of applications. Together with PMAFLEX conduits they offer the highest grade of safety and sealing.

Temperature range:

-40°F to +221°F (-40 °C to +105 °C), or a short time up to +320°F (+160°C)

Content of delivery IP66:

Fitting with pre-assembled universal safety clips (AFN2)

Content of delivery IP68:

Fitting with oval clips (OVN2), conduit and thread seal (NVN3, SVN4)

Features:

- high grade formulated polyamide
- excellent impact strength
- self-extinguishing
- free of halogen, phosphor and cadmium

Part No. IP66	Part No. IP68	Thread metric	Fits to conduit size:		Thread length [mm]	External dim. [mm]
			NW	metric		
I-_VBD-M207GT	I-_VBV-M207	M20 x 1.5	17	20	11.0	47.5 x 73.0
I-_VBD-M257GT	I-_VBV-M257	M25 x 1.5	17	20	12.0	48.5 x 76.0
I-_VBD-M253GT	I-_VBV-M253	M25 x 1.5	23	25	12.0	57.5 x 83.0
I-_VBD-M323GT	I-_VBV-M323	M32 x 1.5	23	25	15.0	61.0 x 87.5
I-_VBD-M329GT	I-_VBV-M329	M32 x 1.5	29	32	15.0	70.5 x 93.0
I-_VBD-M409GT	I-_VBV-M409	M40 x 1.5	29	32	19.0	74.5 x 98.5
I-_VBD-M406GT	I-_VBV-M406	M40 x 1.5	36	40	19.0	85.0 x 121.0
I-_VBD-M506GT	I-_VBV-M506	M50 x 1.5	36	40	19.0	85.0 x 125.0
I-_VBD-M508GT	I-_VBV-M508	M50 x 1.5	48	50	19.0	98.5 x 130.0
I-_VBD-M638GT	I-_VBV-M638	M63 x 1.5	48	50	19.0	98.5 x 138.0

Part No. IP66	Part No. IP68	Thread metric	Fits to conduit size:		Thread length [mm]	External dim. [mm]
			NW	metric		
I-_VBD-P167GT	I-_VBV-P167	16	17	20	11.0	47.4 x 73.0
I-_VBD-P213GT	I-_VBV-P213	21	23	25	12.0	57.5 x 85.0
I-_VBD-P299GT	I-_VBV-P299	29	29	32	12.0	67.5 x 96.0
I-_VBD-P366GT	I-_VBV-P366	36	36	40	13.0	79.0 x 123.0
I-_VBD-P488GT	I-_VBV-P488	48	48	50	13.0	92.5 x 135.0

Fill in the blank with either "B" to order black or "S" to order grey*

*Grey part is a special order, call igus® for availability

For smaller conduit sizes NW 07 to NW 12 appropriate standard elbows of type VW are available

Part No. structure metric

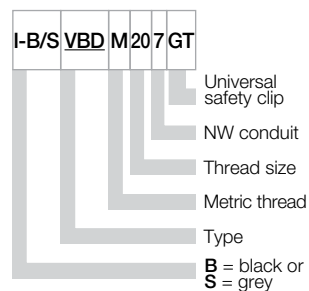

Part No. structure PG

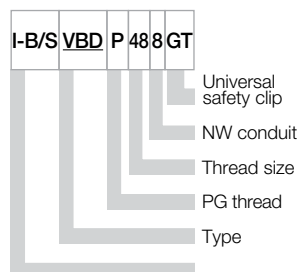



PMAFIX Connectors VO - Flange 90°

These PMAFIX connectors are used in a wide range of applications. Together with PMAFLEX conduits they offer the highest grade of safety and sealing.

Content of delivery IP66:

Fitting with pre-assembled universal safety clips (AFN2), flange seal (FG04)

Content of delivery IP68:

Fitting with oval clips (OVN2), conduit and thread seal (NVN3, FG04)

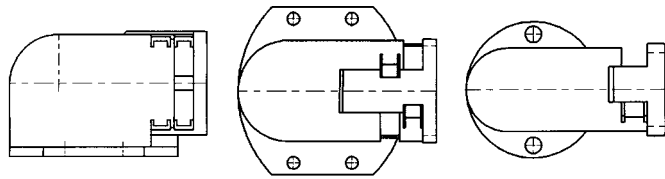

Part No. IP66	Part No. IP68	Fits to conduit size:		Dimensions width x length x depth	Fixing screws
		NW	metric		
I-__VOD-P167GT	I-__VOV-P167	17	20	46.0 x 66.0 x 35.5	2 x M5
I-__VOD-P213GT	I-__VOV-P213	23	25	65.5 x 70.0 x 43.0	2 x M6
I-__VOD-P299GT	I-__VOV-P299	29	32	67.0 x 78.0 x 49.5	4 x M6
I-__VOD-P366GT	I-__VOV-P366	36	40	85.0 x 102.0 x 65.5	4 x M6
I-__VOD-P488GT	I-__VOV-P488	48	50	86.0 x 119.0 x 77.5	4 x M6

Fill in the blank with either "B" to order black or "S" to order grey*

*Grey part is a special order, call igus® for availability

Part No. structure PG

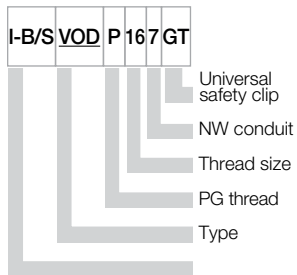

igus®
e-chain system®

Telephone 1-800-521-2747

Internet: igus.com
 email: sales@igus.com
 QuickSpec: igus.com/quickspec

**PMAFIX FH-0 - One-piece system supports**

The one-piece PMACLIP system support is designed for fixation of PMAFLEX conduits. This product can be used in all machine and installation applications for easy assembly of the PMA system.

Temperature range:

-40°F to +221°F (-40 °C to +105 °C), or a short time up to +320°F (+160°C)

Features:

- high grade formulated polyamide
- excellent impact strength
- self-extinguishing
- free of halogen, phosphor and cadmium

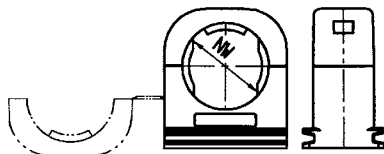

Part No. black	Part No. grey	Fits to conduit size:		Dimensions width x length x depth	Fixing screw
		NW	metric		
I-BFH-07-0	I-SFH-07-0	7	10	17.0 x 21.5 x 20.0	1 x M4
I-BFH-10-0	I-SFH-10-0	10	12	20.5 x 24.5 x 20.0	1 x M5
I-BFH-12-0	I-SFH-12-0	12	16	24.0 x 27.0 x 20.0	1 x M5
I-BFH-17-0	I-SFH-17-0	17	20	30.0 x 34.0 x 20.0	1 x M6
I-BFH-23-0	I-SFH-23-0	23	25	38.5 x 42.0 x 20.0	1 x M6
I-BFH-29-0	I-SFH-29-0	29	32	45.5 x 48.0 x 20.0	1 x M6
I-BFH-36-0	I-SFH-36-0	36	40	55.5 x 56.0 x 20.0	1 x M6
I-BFH-48-0	I-SFH-48-0	48	50	67.5 x 68.0 x 20.0	1 x M6

**PMAFIX VH - System supports**

These PMACLIP system supports are designed for support and guidance of PMA conduits with fine or coarse profile and can be used in all machine building and installation applications. The system is safe against turning/movement and offers maximum security with the additional safety clip, variable assembly due to six hole fastening and optimal strain relief due to integrated rib.

Temperature range:

-40°F to +221°F (-40 °C to +105 °C), or a short time up to +320°F (+160°C)

Features:

- high grade formulated polyamide
- excellent impact strength
- self-extinguishing
- free of halogen, phosphor and cadmium

Part No. Support only	Part No. Locking clip	Part No. Complete	Fits to conduit size:		Dimensions width x length x depth	Fixing screw
			NW	metric		
I-BVH-07	BVH-07-020	BVH-07-000	7	10	17.0 x 21.5 x 20.0	1 x M4
I-BVH-10	BVH-10-020	BVH-10-000	10	12	20.5 x 24.5 x 20.0	1 x M5
I-BVH-12	BVH-12-020	BVH-12-000	12	16	24.0 x 27.0 x 20.0	1 x M5
I-BVH-17	BVH-17-020	BVH-17-000	17	20	35.0 x 36.0 x 36.0	6 x M5
I-BVH-23	BVH-23-020	BVH-23-000	23	25	35.0 x 44.0 x 36.0	6 x M5
I-BVH-29	BVH-29-020	BVH-29-000	29	32	46.0 x 52.0 x 40.0	6 x M5
I-BVH-36	BVH-36-020	BVH-36-000	36	40	53.0 x 58.0 x 60.0	6 x M5
I-BVH-48	BVH-48-020	BVH-48-000	48	50	66.0 x 72.0 x 60.0	6 x M5



PMAFIX GPS - One-piece System supports for stacking

The PMAFIX system supports for stacking are specially designed for increased mechanical requirements in the traction and heavy machine building industries. The one-piece systems supports offer a clasp for easy pre-mounting and final assembly. Fixation in standard rails type C and strain relief due to gripping around the conduit. In addition these products are partially stackable.

Temperature range:

-40°F to +221°F (-40 °C to +105 °C), or a short time up to +320°F (+160°C)

Features:

- high grade formulated polyamide
- excellent impact strength
- self-extinguishing
- free of halogen, phosphor and cadmium

Stacking options

The following nominal widths can be combined for stacking:

- NW 17 with NW23
- NW 29 with NW 36
- NW 48 with NW 56

Part No. fine profile	Fits to conduit size			Dimensions		
	NW	metric	DIN-NW	width	height	depth
BGPS-17	17	20	2	70.0	45.0	30.0
BGPS-23	23	25	2	70.0	45.0	30.0
BGPS-29	29	32	3	85.0	60.0	30.0
BGPS-36	36	40	3	85.0	60.0	30.0
BGPS-48	48	50	4	115.0	90.0	30.0
BGPS-56	56	-	4	115.0	90.0	30.0



PMA MN - Hexagonal Lock Nuts, metric & PG

These hexagonal lock nuts are suitable for a wide range of applications. High torque guarantees a safe connection of the system. Made of reinforced polyamide glass fiber

Temperature range:

-40°F to +221°F (-40 °C to +105 °C), or a short time up to +302°F (+150°C)

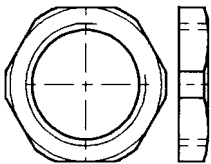

Part No. black	Part No. grey	Fits to thread: metric	Wrench size	Dimensions height
I-BMN-M12	I-GMN-M12	M12 x 1.5	17.0	5.0
I-BMN-M16	I-GMN-M16	M16 x 1.5	22.0	5.0
I-BMN-M20	I-GMN-M20	M20 x 1.5	27.0	6.0
I-BMN-M25	I-GMN-M25	M25 x 1.5	32.0	6.0
I-BMN-M32	I-GMN-M32	M32 x 1.5	41.0	7.0
I-BMN-M40	I-GMN-M40	M40 x 1.5	50.0	7.0
I-BMN-M50	I-GMN-M50	M50 x 1.5	60.0	8.0
I-BMN-M63	I-GMN-M63	M63 x 1.5	75.0	8.0

Part No. black	Part No. grey	Fits to thread: PG	Wrench size	Dimensions height
I-BMN-07	I-GMN-07	7	19.0	5.0
I-BMN-09	I-GMN-09	9	22.0	5.0
I-BMN-11	I-GMN-11	11	24.0	5.3
I-BMN-13	I-GMN-13	13.5	27.0	6.3
I-BMN-16	I-GMN-16	16	30.0	6.3
I-BMN-21	I-GMN-21	21	36.0	7.0
I-BMN-29	I-GMN-29	29	46.0	7.0
I-BMN-36	I-GMN-36	36	60.0	8.0
I-BMN-48	I-GMN-48	48	70.0	8.0

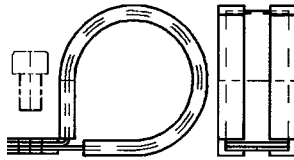

PMA SGB - Tube clamps

These tube clamps are used for the mounting and smooth connection to the PMA conduits in the general machine and installation applications. They are especially suitable for the mounting of static conduits.

Temperature range: -58°F to +221°F (-50 °C to +105 °C)

Features:

- galvanized steel according to DIN 3016
- Elastomer free of halogen

Part No.	Fits to conduit size		Dimensions width [mm]	Fixing screw
	NW	metric		
I-SGB-07	7	10	13.0	1 x M4
I-SGB-09	10	12	13.0	1 x M4
I-SGB-11	12	16	13.0	1 x M4
I-SGB-16	17	20	16.0	1 x M5
I-SGB-21	23	25	16.0	1 x M5
I-SGB-29	29	32	19.0	1 x M6
I-SGB-36	36	40	19.0	1 x M6
I-SGB-48	48	50	19.0	1 x M6



PMA 514 - Plug Screws, metric & PG

These plug screws are suitable for an accurate termination where no thread holes in casing and distribution boxes are needed.

Temperature range: -4°F to +212°F (-20 °C to +100 °C), or a short time up to +302°F (+150°C)

Features:

- product with metric thread: PA-GF
- product with PG thread: PS
- free of halogen, phosphor and cadmium
- IP54

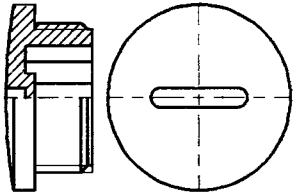

Part No.	Fits to thread metric	Outside Ø [mm]	Total length [mm]	Thread length [mm]
I-514-M12	M12 x 1.5	15.0	8.0	6.0
I-514-M16	M16 x 1.5	20.0	9.0	6.0
I-514-M20	M20 x 1.5	24.0	9.5	6.0
I-514-M25	M25 x 1.5	30.0	11.5	8.0
I-514-M32	M32 x 1.5	37.0	12.0	8.0
I-514-M40	M40 x 1.5	46.0	13.0	8.0
I-514-M50	M50 x 1.5	56.0	15.0	10.0
I-514-M63	M63 x 1.5	70.0	17.0	12.0

Part No.	Fits to thread PG	Outside Ø [mm]	Total length [mm]	Thread length [mm]
I-514-07	7	15.0	8.0	6.0
I-514-09	9	19.0	9.5	6.5
I-514-11	11	22.0	10.0	6.5
I-514-13	13.5	25.0	10.0	6.5
I-514-16	16	27.0	10.0	6.5
I-514-21	21	33.0	12.0	8.0
I-514-29	29	44.0	11.5	8.0
I-514-36	36	55.0	14.0	10.0
I-514-48	48	68.0	16.0	12.0

PMA Connectors - Accessories



PMA

igus®
e-chain system®

Telephone 1-800-521-2747

Internet: igus.com
email: sales@igus.com
QuickSpec: igus.com/quickspec





11.23

Standard Corrugated Conduits						
Products		CYL PA6	VCS PA6	PIS PA12	FH	VH
Tube size: metric	width [mm]	Very flexible, medium wall corrugated conduits	Flexible, very heavy corrugated conduits	Highly flexible medium wall corrugated conduits	PMACLIP - one-piece system support	PMACLIP two-piece system support
10	07	CYLT-07* -	VCST-07* -	PIST-07* -	*FH-07-0	*VH-17-000
12	10	CYLT-10* -	VCST-10* -	PIST-10* -	*FH-10-0	*VH-23-000
16	12	CYLT-12* -	VCST-12* -	PIST-12* -	*FH-12-0	*VH-29-000
20	17	CYLT-17* -	VCST-17* VCSG-17*	PIST-17* PISG-17*	*FH-17-0	*VH-36-000
25	23	CYLT-23* CYLG-23*	- VCSG-23*	PIST-23* PISG-23*	*FH-23-0	*VH-48-000
32	29	CYLT-29* CYLG-29*	- VCSG-29*	PIST-29* PISG-29*	*FH-29-0	
40	36	CYLT-36* CYLG-36*	- VCSG-36*	PIST-36* PISG-36*	*FH-36-0	
50	48	CYLT-48* CYLG-48*	- VCSG-48* VCSG-56* VCSG-70* VCSG-95*	PIST-48* PISG-48*	*FH-48-0	

* = replaced by "B" for black or "S" for gray

T or D = fine profile

G = coarse profile

Standard Corrugated Conduits						
Products		CYL PA6	VCS PA6	PIS PA12	FH	VH
Tube size: metric	width [mm]	Very flexible, medium wall corrugated conduits	Flexible, very heavy corrugated conduits	Highly flexible medium wall corrugated conduits	PMACLIP - one-piece system support	PMACLIP two-piece system support
10	07	CYLT-07* -	VCST-07* -	PIST-07* -	*FH-07-0	*VH-17-000
12	10	CYLT-10* -	VCST-10* -	PIST-10* -	*FH-10-0	*VH-23-000
16	12	CYLT-12* -	VCST-12* -	PIST-12* -	*FH-12-0	*VH-29-000
20	17	CYLT-17* -	VCST-17* VCSG-17*	PIST-17* PISG-17*	*FH-17-0	*VH-36-000
25	23	CYLT-23* CYLG-23*	- VCSG-23*	PIST-23* PISG-23*	*FH-23-0	*VH-48-000
32	29	CYLT-29* CYLG-29*	- VCSG-29*	PIST-29* PISG-29*	*FH-29-0	
40	36	CYLT-36* CYLG-36*	- VCSG-36*	PIST-36* PISG-36*	*FH-36-0	
50	48	CYLT-48* CYLG-48*	- VCSG-48* VCSG-56* VCSG-70* VCSG-95*	PIST-48* PISG-48*	*FH-48-0	

* = replaced by "B" for black or "S" for gray







T or D = fine profile

G = coarse profile

JUMBO Corrugated Conduits PMAGRIP					
Products		PIHG PA12	BGG	BGO	SGS
Tube size: Width [mm]		Highly flexible medium wall corrugated conduits	PMAGRIP- straight	PMAGRIP- 90° angle	PMAGRIP- tube clamps
56		PIHG-56*	*GG-56	*GO-56	SGS-56
70		PIHG-70*	*GG-70	*GO-70	SGS-70
95		PIHG-95*	*GG-95	*GO-95	SGS-95
125		PIHG-125*	*GG-125	-	SGS-125

PMA Connectors - Accessories

PMA

PMAFIX							
Products		IP66 - VN	IP66 - VA	IP66 - VW	IP66 - VB	IP68 - VNZ	MN
Thread Typ		PMAFIX straight	PMAFIX 45° angle	PMAFIX 90° angle	PMAFIX 90° elbow angle	Straight with strain relief	PMA hexagonal lock nuts
M12x1.5		*VND-M12MGT	–	*VWD-M12MGT	–	–	*MN-M12
M12x1.5		*VND-M120GT	*VAD-M120GT	*VWD-M120GT	–	–	*MN-M12
M16x1.5		*VND-M162GT	*VAD-M162GT	*VWD-M162GT	–	*VNZ-M162S	*MN-M16
M20x1.5		*VND-M207GT	*VAD-M207GT	*VWD-M207GT	*VBD-M207GT	*VNZ-M207S	*MN-M20
M25x1.5		*VND-M253GT	*VAD-M253GT	*VWD-M253GT	*VBD-M253GT	*VNZ-M253S	*MN-M25
M32x1.5		*VND-M329GT	*VAD-M329GT	*VWD-M329GT	*VBD-M329GT	*VNZ-M329S	*MN-M32
M40x1.5		*VND-M406GT	*VAD-M406GT	*VWD-M406GT	*VBD-M406GT	*VNZ-M406S	*MN-M40
M50x1.5		*VND-M508GT	*VAD-M508GT	*VWD-M508GT	*VBD-M508GT	*VNZ-M508S	*MN-M50

* = replaced by "B" for black or "S" for gray

PMAFIX						
Products		IP66 - VOD	IP66 - VY	IP66 - FT/VT	IP66 - FV	SGB
Tube size: metric	width [mm]	PMAFIX flange 90°	PMAFIX Y-distribution piece	PMAFIX T-distribution piece	PMAFIX V-distribution piece	PMAFIX-tube clamps
10	07	–	–	–	–	SGB-07
12	10	–	*VYD-100707GT	*FTD-101010GT	*FVD-100707GT	SGB-09
16	12	–	*VYD-121010GT	*FTD-121212GT	*FVD-121010GT	SGB-11
20	17	*VOD-P167GT	*VYD-171212GT	*FTD-171717GT	*FVD-171212GT	SGB-16
25	23	*VOD-P213GT	*VYD-231717GT	*FTD-232323GT	*FVD-231717GT	SGB-21
32	29	*VOD-P299GT	*VYD-292323GT	*FTD-292929GT	–	SGB-29
40	36	*VOD-P366GT	*VYD-362929GT	*FTD-363636GT	–	SGB-36
50	48	*VOD-P488GT	*VYD-483636GT	–	–	SGB-48

* = replaced by "B" for black or "S" for gray

PMAFIX - Order Example

XXXX-10 07 07 XX



PMAFIX - Distribution Piece

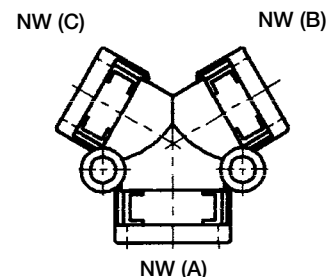
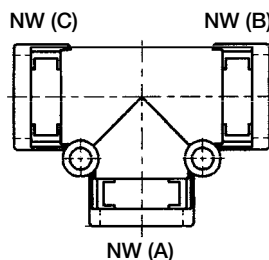
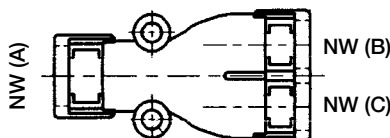

igus®
e-chain system®

Telephone 1-800-521-2747

Internet: igus.com
email: sales@igus.com
QuickSpec: igus.com/quickspec

General Index

Design

Designing with igus®	1.4
Application Examples	1.5
Chain Length calculation, camber	1.8
System Analysis	1.9

Applications

Unsupported – Short Travels	1.11
Unsupported Charts	1.15
Gliding – Long Travels	1.21
Vertical Hanging	1.25
Vertical Standing	1.27
Zig-Zag / leftband	1.28
Side-Mounted	1.29
Rotary Motion	1.31
Twisterchain, twisterband, e-spool	1.34

Cable and Hose Packages

General Rules	1.35
Strain Relief	1.39

Technical Data & Standards

Technical Data	1.41
ESD & ATEX	1.43
Cleanroom & ESD	1.45
Dirt Environments	1.46
Material Data/ igumid® G	1.47
Colors	1.47
Chemical Resistance	1.48
Standards and Certification	1.49

readychain & readycable

readychain®	1.50
readycable	1.59

igus® Assembly Service

Assembly Service	1.61
------------------	------

e-chain® by Series

e-rib

EL.00.23.0	2.11
EL.01.29.0	2.12
EL.00.36.0	2.13
EL.00.48.0	2.14

E1 e-chain®

E1-10	2.23
E1-17	2.24
E1-18	2.25
E1-20	2.26

SnapChain

TE14-50 / TZ14-50	2.30
TE26-120 / TZ26-120	2.32

Office chain

ZF14	2.37
------	------

E-Z chain®

E03	2.47
E04	2.51
E045 / Z045	2.55
E06 / Z06	2.61
E065/Z065	2.65
E08 / Z08	2.71
E14 / Z14	2.75
E200 / Z200	2.79
E16 / Z16	2.85
E26 / Z26	2.89
E300 / Z300	2.95

Zipper Chain

047	3.7
07	3.11
R07	3.15
09	3.19
R09	3.23
15	3.27
R15	3.33
17	3.39
R17	3.45

E-2 Micro

03	4.7
04	4.11
05	4.15
045	4.19
06	4.23
E2-10 / E2i-10 / E2C-10	4.27
B07	4.33

B09	4.37
E2-15 / E2i-15 / E2C-15	4.41
08	4.47

E2 Mini e-chains®

10	4.57
11.031	4.63
11.080	4.67
11.1/11.2	4.71
14	4.75
B15 / B15i	4.79
B17 / B17i	4.85
F17	4.91

E2/000 e-chains®

1400 / 1500	4.103
1450 / 1480	4.113
2400 / 2500	4.121
2450 / 2480	4.131
2600 / 2700	4.141
2650 / 2680	4.151
3400 / 3500	4.161
3450 / 3480	4.171
255	4.181

R100 tubes

R117 / R118	5.9
R157 / R158	5.15
R167 / R168	5.23

R tubes

R48	5.33
R58	5.41
R68	5.49

R2.1 tubes

R2.75	5.61
-------	------

RX tubes

RX32	5.73
RX40	5.77
RX48	5.81
RX56	5.85

E4-1 e-chain®	
E4-21	6.9
E4-28	6.15
E4-32	6.27
E4-42	6.41
E4-56	6.57
E4-80	6.73
E4-112	6.89
E4-162	6.103
600 / 601 / R608	6.109
800	6.117
840	6.123
E4-350	6.131

E4-1 Light e-chain®	
E4-31L / R4-31L	6.143
E4-38L / R4-38L	6.153
E4-48L / R4-48L	6.165
E4-64L	6.179

E4/light e-chain®	
14040 / 14140 / R18840	6.193
14240 / 14340	6.205
14550 / 14650 / R19050	6.217
15050 / 15150 / R19850	6.227
15250 / 15350	6.241
1640 / R1608	6.251

T3 e-chain®	
T3-29	7.11

E3 e-chain®	
E3-10	7.23
E3-15	7.27
E3-22	7.31

E6-1 e-chain®	
EF61.29	7.41
E61-29	7.41
E61.35	7.47
E61.40	7.53
E61.52	7.61

E6 e-chain®	
E6-29	7.71
R6-29	7.77
E6-35	7.81
E6-40	7.87

R6-40	7.93
E6-52	7.97
R6-52	7.103
E6-62	7.107
E6-80	7.115
E6-80L	7.125

e-skin	
SK28	7.141
SK40	7.145

TH3	
TH3.25	7.153
TH3.45	7.159

triflex® R	
TRC	8.13
TRE	8.15
TRCF	8.17
TRL	8.19
TRLF	8.21

Cable management systems	
Cobots	8.39
RSE linear	8.47
RS modular	8.53
RSP pneumatic	8.57
RSE wheel	8.63
RSEL linear	8.69

E-Z triflex®	
E331	8.90
E332	8.91
E333	8.93

triflex®	
331/351	8.103
332/352	8.104
333/353	8.105

twisterchain®	
2208	8.115
TC-32	8.117
TC-42	8.119
TC-56	8.121

twisterband	
TB12	8.137

TB20	8.137
TB29	8.137
TB30	8.137

twisterband HD	
TBHD30	8.141
TBHD42	8.141

Special Solutions	
e-spool	9.7
liftband	9.26
guidelok p / p.s	9.32
guidelok horizontal	9.38
basic flizz®	9.42
micro flizz®	9.46
isense - predictive maintenance	9.56
PPDS	9.72
Modular projects	9.76

e-chains® for long travels	
E4/4HD	9.87
P4	9.117
rol e-chain®	9.139
autoglide	9.155

Guide Trough	
Super-aluminum trough	9.197
Steel trough	9.223
Support tray	9.247
guidefast	9.257
guidelite	9.261

Strain Relief	
Clamps	10.17
Tiewrap plates	10.21
CFU Honeycomb strain relief	10.25
Strain relief separators	10.27
Strain relief element	10.31
Chainfix nuggets	10.32
Strain relief connector system	10.33

PMA Tubing	
PACOF	11.5
PPCOF	11.6
LN / LNO	11.7
VCS	11.8
PIS/PIH	11.9
CYL	11.10

igus[®] locations



e-chain[®] North American locations

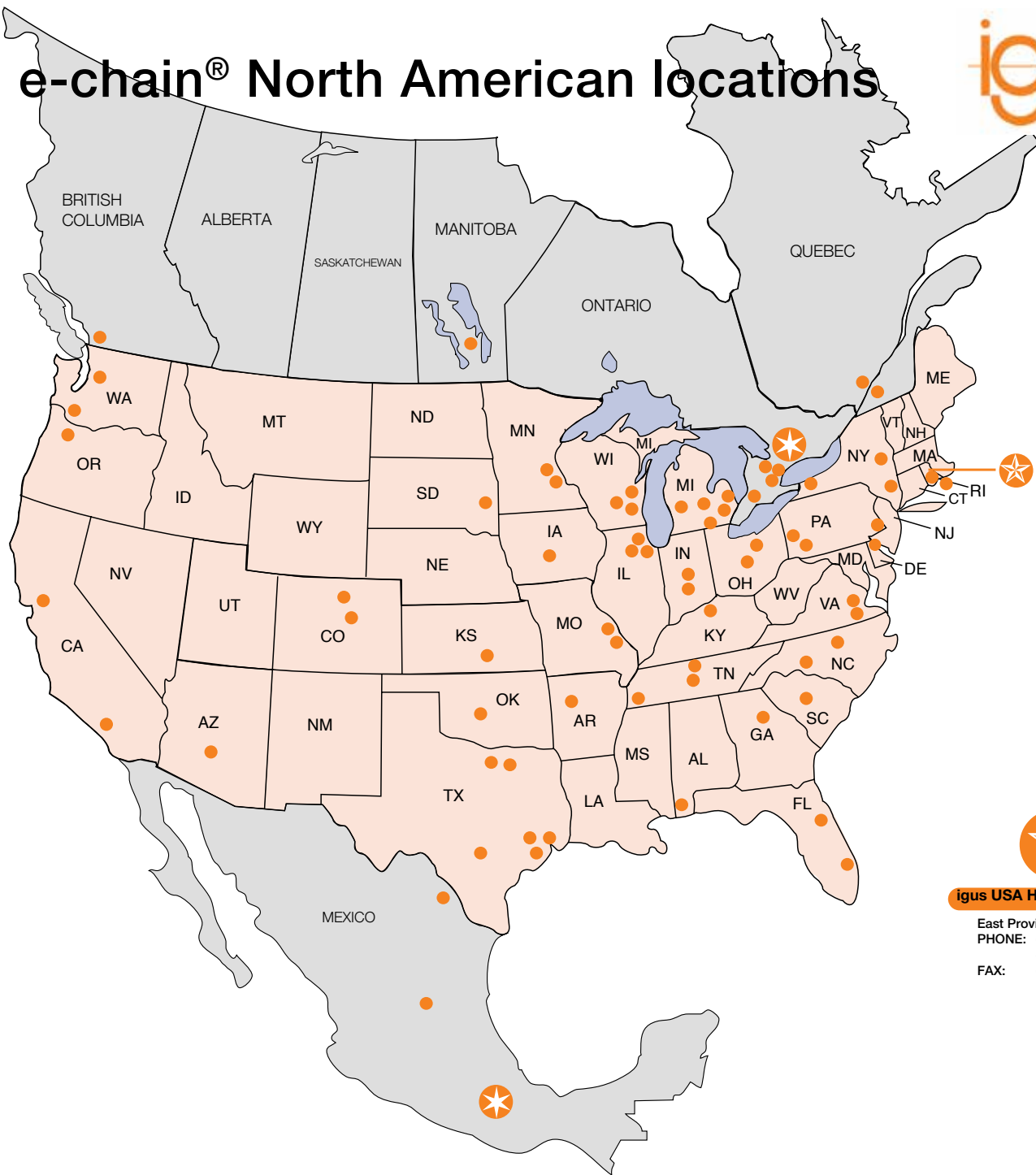

igus USA Headquarters

East Providence, RI
PHONE: (800) 521-2747
(401) 438-2200
FAX: (401) 438-7270

North American Satellite Offices



igus CANADA

Concord, ONT
PHONE: (800) 965-2496
(905) 760-8448
FAX: (905) 760-8688



igus MEXICO

Toluca, MX
PHONE: (728) 284-3185
FAX: (728) 284-3187

Visit www.igus.com
for a complete list of our offices.

igus® worldwide

igus® Offices	10 Canada	20 Estonia	28 Ireland	39 Mexico
igus® Distributors	igus® Office Canada Suite 100-180 Bass Pro Mills Dr Vaughan, ON L4K 5W4 Phone +1 905 7608448 Fax +1 905 7608688 webmaster@igus.com	igus® OÜ Lõotsa 4A Tallinn 11415 Phone +372 667 5600 Fax +372 667 5601 info@igus.ee	igus® Ireland Caswell Rd Northampton NN4 7PW Phone +44-1604 677240 Fax +44-1604 677242 sales@igus.ie	igus® México S. de R.L. de C.V. Boulevard Aeropuerto Miguel Alemán 160 Int. 135 Col. Corredor Industrial Toluca Lerma Lerma, Estado de México C.P. 52004 Phone +52 728284 3185 Fax +52 728284 3187 fmarquez@igus.com
1 Germany	11 Chile	21 Finland	29 Israel	40 Middle East (except of UAE)
igus® GmbH Spicher Str. 1a 51147 Köln P.O. Box 90 61 23 51127 Köln Phone 02203 9649-0 Fax 02203 9649-222 info@igus.de, www.igus.de	Vendortec Avda. Los Pajaritos 3195, Oficina 1410 Edificio Centro Maipú Maipú - Santiago Phone +56 22 710 58 25 +56 23 245 02 00 ventas@vendortec.cl	OEM Finland OY Fiskarsinkatu 3 20750 Turku PL 9, 20101 Turku Phone +358 20 7499499 Fax +358 20 7499456 info@oem.fi	Conlog LTD P.O. Box 3265 17 Hamefalssim Str. Industrial Zone Kiryat Arie Petach-Tikva 49130 Phone +972 3 9269595 Fax +972 3 9233367 conlog@conlog.co.il	JISig Middle East FZE FF07, Jebel Ali Free Zone PO Box- 17483 Dubai, United Arab Emirates Phone +971 4222 1185 Fax +971 4222 1186 info@jisigus.com
2 Argentina	12 China	22 France	30 Italy	41 Myanmar
Borintech SRL Av. Elcano 4971 C1427CIH Buenos Aires Phone +5411 4556 1000 Fax +5411 4556 1000 igus@borintech.com	igus® Shanghai Co., Ltd. No.50, North Huancheng Road Fengxian district Shanghai 201401 P. R. China Phone +86 21 8036 6999 Fax +86 21 8036 6116 cnmaster@igus.net	igus® SARL 49, avenue des Pépinières Parc Médicis 94260 Fresnes Phone +33 1 49840404 Fax +33 1 49840394 info@igus.fr	igus® S.r.l. Via delle Rovedine, 4 23899 Robbiate (LC) Phone +39 039 5906.1 Fax +39 039 5906.222 igusitalia@igus.it	Sea Lion Co. Ltd. 181 Bo Myat Tun St Botataung Yangon 11161 Myanmar Phone +95 1 29 97 97 Fax +95 1 20 27 51 zaw.m.thant@sealionmyanmar.com
3 Australia	13 Colombia	23 Greece	31 Japan	42 Netherlands
Treotham Automation Pty. Ltd. 14 Sydenham Road Brookvale NSW 2100 Phone +61 2 9907-1788 Fax +61 2 9907-1778 info@treotham.com.au	Productos SAS Calle 33A, #21-09 Bogotá Phone +57 1 561 2959 ext. 113 igus@igus.com.co	J. & E. Papadopoulos S.A. 12 Polidefkous str Piraeus, 185 40 Phone +30 210 4113133 Fax +30 210 4116781 sales@papadopoulos-sa.com	igus® k.k. Arcacentral 15F, 1-2-1 Kinshi, Sumida-ku Tokyo JAPAN Zip 130-0013 Phone +81 358 192030 Fax +81 358 192055 info@igus.co.jp	igus® B.V. Sterrenbergweg 9 3769 BS Soesterberg Phone +31 346 353932 Fax +31 346 353849 info@igus.nl
4 Austria	14 Costa Rica	23 Greece	32 Kenya	42 Netherlands – dry-tech®
igus® polymer Innovationen GmbH Photo-Play-Straße 1 4860 Lenzing Phone +43 7662 57763 Fax +43 7662 57751 igus-austria@igus.de	Enesa Equipos Neumaticos S.A. Del Colegio Marista 100 este, 200 sur, 25 este Urbanizacion Ciruelas Alajuela, Costa Rica Phone +506 2440-2393 Fax +506 2440-2393 equiposneumaticos@enesa.net	Chrismotor s.a. 71, Sp. Patsi str. 118 55 Athens Phone +30 210 34 25574 Fax +30 210 3425595 info@chrismotor.gr	Mantrad Ltd. Sterling House, 1St. Floor Moi Avenue, Mombasa Phone + 254 722 706 830 Fax + 254 720 765 566 info@mantrad.co.ke	Elcee B.V. Kamerlingh Onnesweg 28 NL-3316 GL Dordrecht Phone +31 (0)78-654 47 77 Fax +31 (0)78-654 47 33 info@elcee.nl
5 Belarus	15 Croatia	24 Hong Kong	33 Latvia	43 Nigeria
SOOO Hennlich Biryuzova street, 4/5, office 1012 220073 Minsk Republik Belarus Phone +375 17 258 88 28 Fax +375 17 373 39 26 info@hennlich.by	Hennlich, Industrijska d. o. o. Stupničkoobreška 17 Stupnički Obrež 10255 Gornji Stupnik Phone +385 1 3874334 Fax +385 1 3874336 hennlich@hennlich.hr	Sky Top Enterprises Ltd. Room 1806 ; Block C; Wah Tat Industrial Center; Wah Sing Street; Kwai Chung Hong Kong Phone +852 23318928 Fax +852 24269738 info@skyytop.com.cn	Techvitas SIA Daugavas iela 38-3 Mārupe, LV-2167 Phone +372 667 5600 Fax +372 667 5601 i_igusLettland_G@igus.de	Deepee Industrials Ltd. 11 Ishaga Road Surulere Lagos Phone +234 803 3899107 ovoachinike@deepeeindustrials.com
6 Belgium/Luxembourg	16 Czech Republic	25 Hungary	34 Lebanon	44 New Zealand
igus® B.V.B.A. Jagersdreef 4A 2900 Schoten Phone +32 3 330 13 60 Fax +32 3 313 79 91 info@igus.be	HENNLICH s.r.o. Českolipská 9 412 01 Litoměřice Phone e-chains® +420 416 711332 Phone Plain bearings +420 416 711339 Fax +420 416 711999 lin-tech@hennlich.cz	igus® Hungária Kft. Ipari Park u.10. 1044 Budapest Phone +36 1 3066486 Fax +36 1 4310374 info@igus.hu	Mecanix Shops SAL Horsh Tablet - Ste Rita blvd P.O.Box: 55384 Beirut Phone +961 1 486701 Fax +961 1 490929 sales@mecanixshops.com	Treotham Automation Pty Ltd. Stocking Distributor 13c Vogler Drive Wiri Auckland 2104 Phone +64 9 278 6577 Fax +64 9 278 6578 info@treotham.co.nz
7 Bosnia + Herzegovina	17 Denmark	26 India	35 Lithuania	45 Norway
HENNLICH industrijska tehnika d.o.o. Tvornička 3 (Energoinvest-zgrada C&O) BiH-71210 Ilidža - Sarajevo Phone +387 33 451 439 Fax +387 33 451 439 info@hennlich.ba	igus® ApS Lysholt Alle 8 DK-7100 Vejle Phone +45 86 603373 Fax +45 86 60 32 73 info@igus.dk	igus® (India) Pvt. Ltd. 36/1, Sy No. 17/3 Euro School Road, Dodda Nekkundi Industrial Area, - 2nd Stage Mahadevapura Post Bangalore 560048 Phone +91 80 68127800 Fax +91 80 68127802 info-in@igus.net	Hitech UAB Terminalo g. 3 54469 Biruliškiu k. (Kauno LEZ) Kauno raj. Phone +370 37 323271 Fax +370 37 203273 info@hitech.lt	ASI Automattik AS Sankt Hallvards vei 3, port 8 3414 Lierstranda Phone +47 9006 1100 info@asiflex.no
8 Brazil	18 Ecuador	27 Indonesia	36 Macedonia, Albania, Kosovo	46 Peru
igus® do Brasil Ltda. Rua Antônio Christi, nº 611 Parque Industrial III – FAZGRAN Jundiá – CEP 13213-183 – SP Phone +55 11 3531-4487 Fax +55 11 3531-4488 vendas@igus.com.br	Ecuainsetec Yugoeslavia N34-110 y Azuay Quito Phone +593 2 2253757 Fax +593 2 2461833 info@ecuainsetec.com.ec	PT igus® Indonesia Headquarter Indonesia Taman Tekno BSD Sektor XI, Blok L1 No. 15 Tangerang Selatan 15314 Phone +62 21 7588 1933 Fax +62 21 7588 1932 info@igus.co.id	Hennlich doo Beograd Radomira Markovića 1/3 11222 Beograd Phone +381 11 63 098 17 Fax +381 11 63 098 20 office@hennlich.rs	PROIGUS S.A.C. Calle Bolivar 388/of. 203 Miraflores Lima 18 – Perú Phone +51 1 2414370 Fax +51 1 2428608 profacoventas@profaco.com
9 Bulgaria	19 Egypt	37 Malaysia	38 Morocco	47 Pakistan
igus® EOOD 2, Lui Ayer str., fl.4, off. 4 1404 Sofia, Bulgaria Phone +359 2 850 8409 Fax +359 2 850 8409 info@igus.bg	IEE International Company for Electrical Engineering 2nd floor, 25 Orabi St Down Town, Cairo Phone +202 25767370 Fax +202 25767375 sales@iee-egypt.com	igus® Malaysia Sdn Bhd Suite 1601-1, Level 16, Tower 2, Wisma AmFirst, Jalan SS 7/15 (Jalan Stadium), 47301 Kelana Jaya, Selangor Phone +603 7803 0618 Fax +603 7886 1328 info@igus.my	AFIT 5, Rue Amir Abdelkader 20300 Casablanca Phone +212 522 633769 Fax +212 522 618351 souria.vu@premium.net.ma	GEMS International Trading 501, Windsong Place, Block 7&8, K.C.H.S, Off Shaheed-e-Millat Rd. Karachi - 75350 Phone +92 21 34531505 marketing@gemsinter.com
9 Bulgaria				48 Philippines
Hennlich OOD, BG 4003 Plovdiv, Bulgaria 147A, Brezovsko shose Str., Rota center, fl. 3 Phone +359 32 511 326 Fax +359 32 621 929 office@hennlich.bg				Silicon Exponents Corp. Unit 1-B, 8414 LMN Bldg. Dr. A. Santos Avenue Brgy.BF Homes Suicat Parañaque City 1700 Philippines Phone +63 2 8250 126/135 Fax +63 2 8250 141 ryemrigor@sieplus.ph

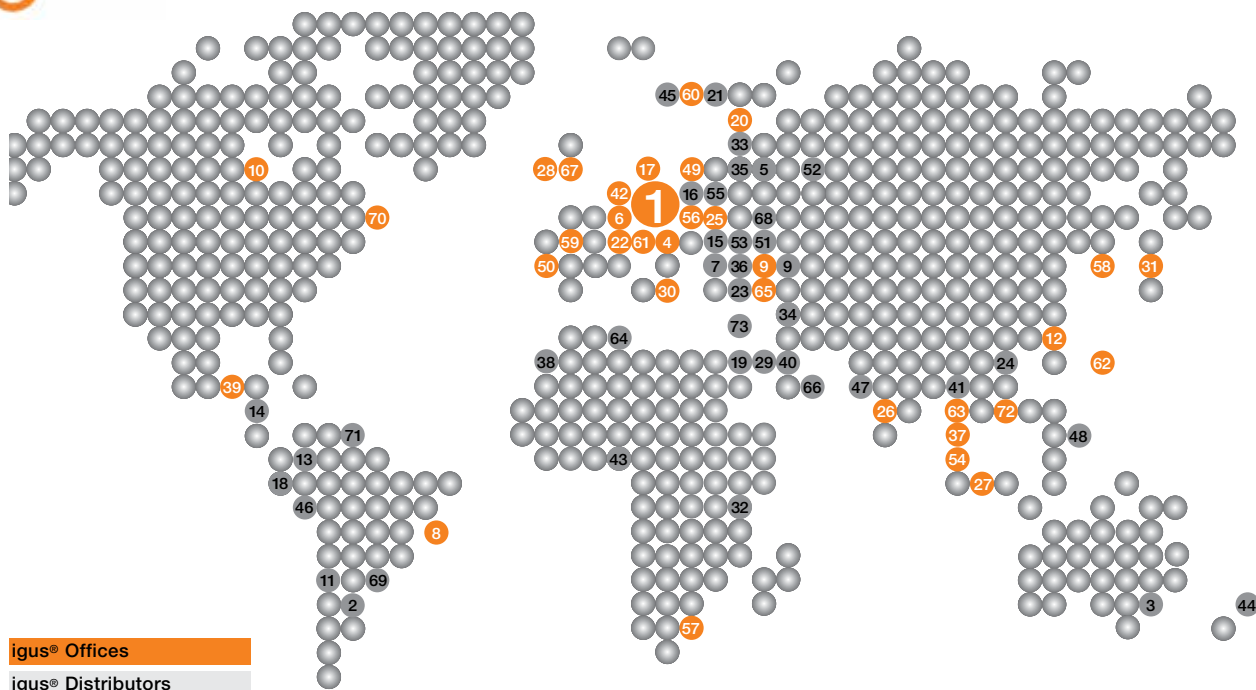

igus® Offices

igus® Distributors

49 Poland

igus® Sp. z o.o.
ul. Działkowa 121C
02-234 Warszawa
Phone +48 22 8635770
Fax +48-22 8636169
info@igus.pl

50 Portugal

igus® Lda.
R. Eng. Ezequiel
Campos, 239
4100-231 Porto
Phone +351 22 6109000
Fax +351 22 8328321
info@igus.pt

51 Romania

Hennlich SRL
Str. Patria, Nr17
310106 Arad
Phone +40 257 211119
Fax +40 257 211021
igus@hennlich.ro

52 Russia

OOO Hennlich
Room 14
Naberezhnaya reki Lazuri, 15A
170028 Tver
Russian Federation
Phone +7 4822 787 180
Fax +7 4822 787 180, add. 380
hennlich@hennlich.ru

53 Serbia + Montenegro

Hennlich doo Beograd
Radomira Markovica 1/3
11222 Beograd / Srbija
Phone +381 11 63 098 17
Fax +381 11 63 098 20
office@hennlich.rs

54 Singapore-ASEAN HQ

igus® Singapore Pte Ltd
84 Genting Lane
#06-03 Axxel Innovation Centre
Singapore 349584
Phone +65 6487 1411
info@igus.com.sg

55 Slovakia

Hennlich s.r.o.
Na Bystricku 16
SK-036 01 Martin

56 Slovenia

igus® d.o.o.
Tržaška c. 134
1000 Ljubljana
Slovenija
Mob. +386 (0)30 601 610
info@igus.si

56 Slovenia

Hennlich, d. o. o.
Industrijska tehnika
Podnart 33
SI-4244 Podnart
Phone +386 4 53206-10
Fax +386 4 53206-20
info@hennlich.si

57 South Africa

igus® Pty. Ltd.
Unit 29
Midline Business Park
Cnr Le Roux & Richards Drive
Midrand 1682
Phone +27 11312-1848
Fax +27 11312-1594
sales.sa@igus.de

58 South Korea

igus® Korea Co. Ltd.
613-14 Namchondong,
Namdonggu
Incheon City, 405-846
Phone +82 32 82129-11
Fax +82 32 82129-13
info@igus.kr

59 Spain

igus® S.L.U.
Ctra. Llobatona, 6
Poligono Noi del Sucre
08840 Viladecans – BCN
Phone +34 936 473950
Fax +34 936 473951
igus.es@igus.es

60 Sweden

igus® AB
Berga Allé 1
254 52 Helsingborg
Phone +46 42 329270
Fax +46 42 211585
info@igusab.se

60 Sweden – the-chain

OEM Automatic AB
Box 1011 Dalagatan 4
573 28 Tranås
Phone +46 75 2424100
Fax +46 75 2424159
info@oemautomatic.se

60 Sweden – dry-tech®

Colly Components AB
Raseborgsgatan 9
P.O. Box 76
164 94 Kista
Phone +46 8 7030100
Fax +46 8 7039841
info@me.colly.se

61 Switzerland

igus® Schweiz GmbH
Winkelstr. 5
4622 Egerkingen
Phone +41 62 388 97 97
Fax +41 62 388 97 99
info@igus.ch

62 Taiwan

igus® Taiwan Company Ltd.
5F, No. 35, 24th Road
Taichung Industrial Park
Taichung 40850
Phone +886 4 2358-1000
Fax +886 4 2358-1100
info@igus.tw

63 Thailand

igus® Thailand Co., Ltd
1340 Soi Bangkok-Nonthaburi 30,
Bangkok-Nonthaburi Rd.,
Bangsue, Bangsue
Bangkok 10800
Phone +66 (0)2 587 4899
Fax +66 (0)2 587 4898
info@igus.co.th

64 Tunisia

BOUDRANT
53, Avenue de Carthage
1000 Tunis – Tunisia
Phone +216 71340244
Fax +216 71348910
info@boudrant.com.tn

65 Turkey

igus® Turkey
Güzeller Org. San. Bölğ.
Galvano Teknik San. Sit.
Cumhuriyet Cad. 2/32
P.K. 41400 Gebze / Kocaeli
Phone +90 262 502 14 08
Fax +90 262 502 14 19
info@igus.com.tr

65 Turkey

HIDREL Hidrolik Elemanlar
Sanayi ve Ticaret A.S.
Percemli Sk. No. 7
Tünel Mevkii
34420 Karaköy / Istanbul
Phone +90 212 2494881
Fax +90 212 2920850
info@hidrel.com.tr

66 UAE + Oman

Unigroup FZE
Plot of Land M6-01
Sharjah Airport Free Zone
P.O. Box 120300
Sharjah - U.A.E.
Phone +971 6 5578386
Fax +971 6 5578387
automation@unigroup.ae

67 United Kingdom

igus®
Caswell Rd
Northampton NN4 7PW
Phone +44 1604 677240
sales@igus.co.uk

68 Ukraine

Hennlich Ukraine LLC (HQ)
Kramatorska Street 15
84100 Sloviansk City,
Donetsky Region
Phone +38 06262 33540
hennlich@hennlich.com.ua

68 Ukraine

Cominpro GmbH
Romena Rollana 12,
Office 100
61058 Kharkov
Phone +380 57 7174914
Fax +380 57 7174914
cominpro@gmail.com

69 Uruguay

Larrique Rulemanes SA
Galicia 1204
Montevideo-Uruguay
Phone +598 29021773
Fax +598-29084824
larrique@larrique.com.uy

70 USA

igus® inc.
257 Ferris Avenue
P.O. Box 14349
East Providence
RI 02914
Phone +1 401 4382200
Fax +1 401 4387270
webmaster@igus.com

71 Venezuela

Neumatica Rotonda C.A.
Prolong Av. Michelena
C.C. Atlas Locales B-10 y
B-11
Valencia, Edo. Carabobo
Phone +58 241 832.64.64
+58 241 832.32.50
+58 241 838.88.19
Fax +58 241 832.62.83
ventas@neumaticar.com

72 Vietnam

igus® Vietnam Company Ltd
177 Huynh Lan Khanh Street,
Ward 2
District Tan Binh, HCM City,
Vietnam
Phone +84 28 3636 4189
info@igus.vn

73 Zypern

G.C.V. Spare Parts & Services Ltd (HQ)
Industrial Area Anatoliko
8068 Pafos
Phone +357 26 812444
Fax +357 26 812447
igus@gcv-parts.com

9001:2015

igus® is certified in accordance with ISO 9001:2015 and IATF 16949:2016 in the field of energy supply systems, cables and harnessing, as well as plastic bearings.

igus.com

Shop online 24/7!

More catalogs and brochures online –

www.igus.com/downloads

No minimum order quantities, no surcharges.

100,000 products available from stock.

IN THE USA:

257 Ferris Avenue

East Providence, RI 02914

Tel.: 1-800-521-2747

Fax: 1-401-438-7270

IN MEXICO

Igus Mexico S. de R.L de C.V

Bldv. Aeropuerto 160 Int 135

Col. Corredor Industrial Toluca-Lerma

Toluca, C.P 52004

Tel.: (52) 728-284-3185

Fax: (52) 722-271-4274

IN CANADA:

180 Bass Pro Mills Drive, Suite 100

Concord, Ontario

Canada L4K 0B9

Tel.: 1-800-965-2496

Fax: 1-905-760-8688

We also offer over 1,400 types of motion cables.

Call or email us for your copy of our chainflex® cable catalog.

sales@igus.com

Refer to our website for a complete list of our sales locations.



plastics!